

# GATE VALVE FOR HIGH PRESSURE

MOD. 11030

MOD. 11031

MOD. 11032

PN 25

PN 40

PN 63

DN 40-600

DN 40-600

DN 40-400



Metal seated gate valve, rising stem, for application with high working pressures.

## SPECIAL FEATURES

- Manufactured according to the requirements of EN 1984 and EN 10434, complete with flanged connection according to EN 1092, face to face dimensions according to EN 558 (series 15 for PN 25 and PN 40, series 26 for PN 63).
- on demand the valve can be designed and realised according to American standards API600 and with flange dimensions according to ASTM class 150-600.
- Secondary sealing system by compression of stuffing box between stem and bonnet.
- Manual operation -according to dimensions - by handwheel or gearbox.

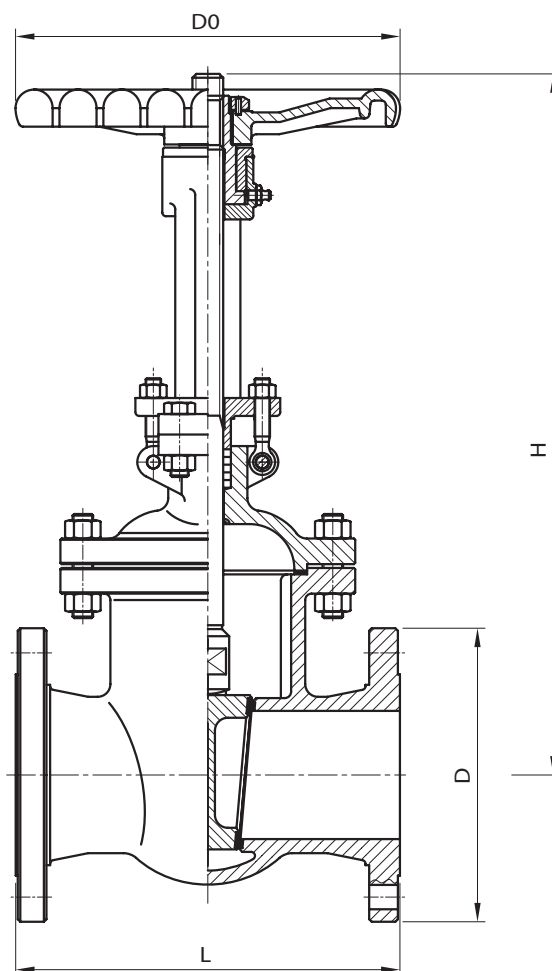

# GATE VALVE FOR HIGH PRESSURE

## MATERIALS

**Body and bonnet:**

Cast steel ASTM 216 Gr. WCB (equivalent to Fe510), internal and external epoxy coated

**Spindle:**

Stainless steel ASTM A276 410 (equivalent to AISI410)

**Wedge:**

Cast steel ASTM 216 Gr. WCB (equivalent to Fe510), coated for protection against corrosion

**Screws:**

Steel ASTM A139 B7

**Nuts:**

Steel ASTM A194 2H

DN	PN	D	L	H	D0
40	25	150	240	350	200
	40				200
	63				200
50	25	165	250	358	250
	40				280
	63				280
65	25	185	270	375	250
	40		290		280
	63				280
80	25	200	280	433	300
	40		310		300
	63				300
100	25	235	300	502	350
	40		350		300
	63				350
125	25	270	325	612	350
	40		400		350
	63				400
150	25	300	350	676	350
	40		450		350
	63				450
200	25	360	400	820	400
	40		550		400
	63				500
250	25	425	450	969	400
	40		650		400
	63				600
300	25	485	500	1142	500
	40		750		450
	63				450
350	25	555	550	1280	500
	40		850		450
	63				450
400	25	620	600	1452	500
	40		950		450
	63				600
500	25	730	700	1676	600
	40	755	1150	1876	600
600	25	845	800	1874	600
	40	890	1350	2285	600