

WIDE RANGE FLANGE ADAPTORS

raci
raci
raci

MOD. 9300 | **PN 10/16** | **DN 50-600**

Wide range flange adaptor.

MOD. 9310 | **PN 10/16** | **DN 80-300**

Wide range flange adaptor, restraint type.



SPECIAL FEATURES

- Universal flange adaptor with large range (up to 54mm) for Cl, DI, steel, AC, PVC and PEAD pipes.
- Body and compression ring high quality EPOXY powder coated (fusion bonded), coating thickness (DFT min. 250 microns).
- Special tightening system with one bolt resp. two bolts for DN \geq 300 dimensions.
- Internal compression ring and bolt/nut/washer from fully corrosion-free material.
- Dual-gasket pressure assisted hydraulic sealing system.
- The gasket is made in two layers, with a removable inner layer that allows for pipe diameter range expansion.
- Easily to be handled by one person even up to big diameters.
- Model 9300 non-restraint type, it is suggested the anchoring of pipeline.
- Ask to raci for ranges and availability of model 9310 (restraint).



All metal, rubber, and coatings used have been designed for contact with water for human consumption, pursuant to the terms of Italian Health Ministry decree n° 174, dated 6/4/2004.

WIDE RANGE FLANGE ADAPTORS

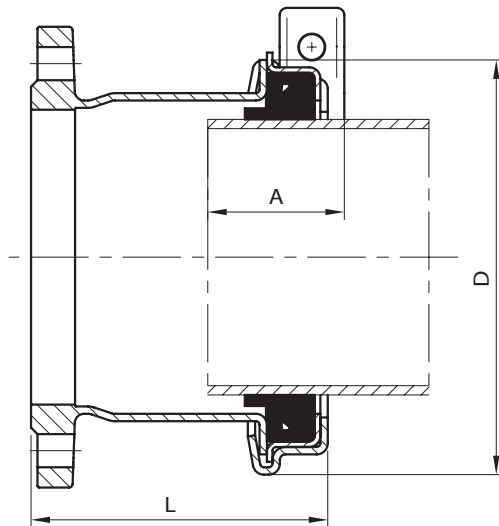

MATERIALS

Body:

Steel S235JR EN 10250
(equivalent to UNI Fe360B DIN St37.2)

Compression ring:

Steel S235JR EN 10250
(equivalent to UNI Fe360B DIN St37.2)

Gasket:

EPDM Rubber, potable water approved

Internal compression ring, bolts/nuts/washers:

Stainless steel 1.4301 EN ISO 10088
(equivalent to AISI 304), with special
anti-friction treatment

DN	Ø _{min.} (RANGE inf.)	Ø _{max.} (RANGE sup.)	L	D	A	Weight (kg)
50	54 (54-66)	77 (65-77)	170	133	55	2,8
80	88 (88-99)	108 (98-108)	220	170	55	3,2
100	108 (108-126)	143 (125-143)	223	220	55	7,5
125	130 (130-146)	162 (145-162)	275	240	55	8,5
150	158 (158-174)	190 (173-190)	275	270	55	9,3
150	163 (163-179)	195 (178-195)	275	273	55	9,3
175	190 (190-206)	222 (205-222)	275	298	55	9,4
200	217 (217-233)	250 (232-250)	275	328	55	10,3
250	272 (272-289)	305 (288-305)	275	382	55	12,7
250	278 (278-295)	311 (294-311)	275	388	55	13
300	315 (315-331)	347 (330-347)	275	422	55	14
300	334 (334-350)	366 (349-366)	275	440	55	15
350	378 (378-408)	434 (407-434)	295	534	100	31
400	434 (434-462)	488 (461-488)	295	588	100	34
450	488 (488-504)	542 (504-542)	295	649	100	39
500	495 (495-523)	549 (522-549)	295	685	100	40
500	540 (540-574)	594 (573-594)	295	700	100	42
600	606 (606-634)	660 (633-660)	295	778	100	47
600	624 (624-652)	678 (651-678)	295	778	100	48

All metal, rubber, and coatings used have been designed for contact with water for human consumption, pursuant to the terms of Italian Health Ministry decree n° 174, dated 6/4/2004.