

**MOD. 13100/L** | **PIPE DN 450-1600**  
**H. 25-41-50-75-100-125-150-175-200 mm**



Collare distanziatore per condotte in tubi di protezione.

### CHARACTERISTICS

- Modular system to assemble insulator rings, which allows spacers to be used on a wide pipe diameter range therefore reducing inventory costs.
- Spacers are quickly and easily assembled by manually fitting elements one into the other.
- The tooth insertion method allows on site adjustments to fit a wide range of pipe diameters.
- Spacers are manufactured entirely out of high density polyethylene (HDPE). No metal bolts or attachments are required.
- A low friction coefficient guarantees an easy insertion into the casing.
- New design with special reinforcing ribs to guarantee high mechanical performances even with reduced thickness.
- Designed and tested to maintain continuous and long term support for the carrier pipe and its contents.
- Spacers provide a constant projection around the entire circumference of the carrier pipe.
- Spacers provide long term protection from corrosion.
- Spacers can be installed on steel-coated pipes, concrete pipes, ductile iron pipes or plastic pipes.
- Heights 25 mm and 41 mm homologated according to SNAM RETE GAS specification (GASD A 09.01.06 and GASD C 09.06.00).
- Tightening by tool type A75 for height up to 75 mm, tool type A200 for height from 100 up to 200mm.

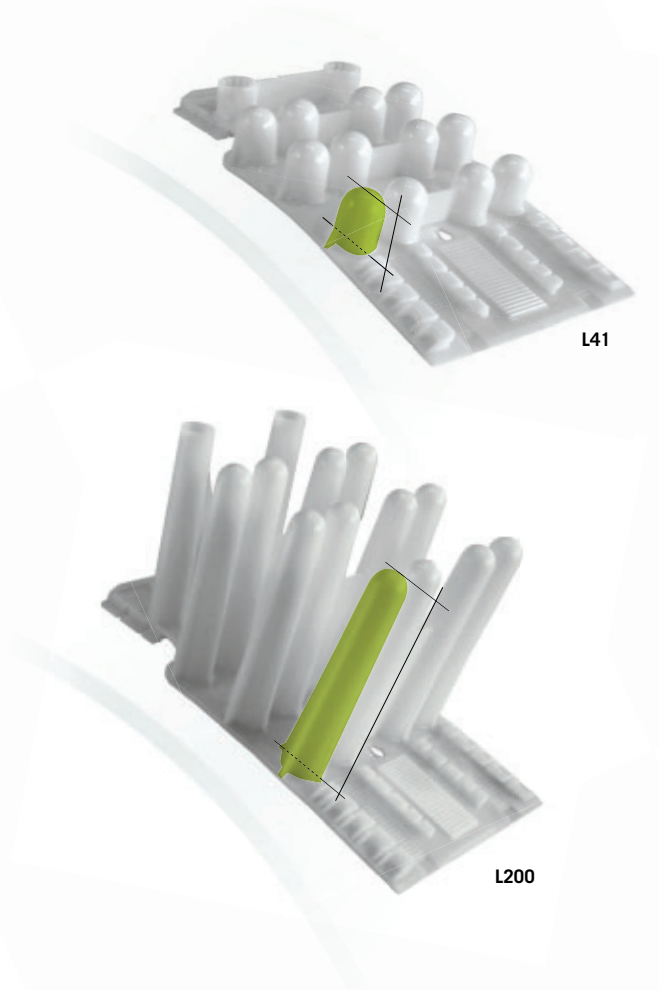

### MATERIAL - HDPE

- Yield strength\*:**  
≥ 25 N/mm<sup>2</sup> (test according to UNI EN ISO 527-2)
- Elongation at break\*:**  
> 200% (test according to UNI EN ISO 527-2)
- Hardness shore D:**  
64 - ASTM D 2240
- Minimum working temperature:**  
- 20°C (for applications below 5°C contact Raci)
- Minimum stocking temperature:**  
- 5°C (for applications below 5°C contact Raci)
- Dielectric strength:**  
> 37 kV/mm - ASTM D 149/64
- UVL stabilization:**  
Good

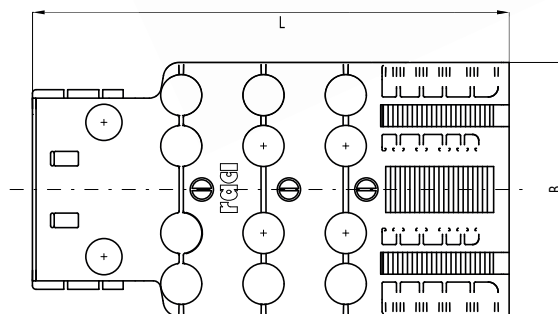
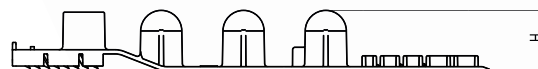

eL

(\* ) on test specimen with moulded material, realized and tested for every batch of production. Batch number is marked on each element recording nr/year of moulding.

TYPE	USEFUL LENGTH		WIDTH (B)		HEIGHT (H)		LOADING CAPACITY (kg)
	mm	inch	mm	inch	mm	inch	
L25-L41-L50	280 - 325	11 - 12,8	210	8,3	25 - 41 - 50	0,98 - 1,61 - 1,97	3000
L75-L100					75 - 100	2,95 - 3,94	2500
L125					125	4,92	2000
L150-L175-L200					150 - 175 - 200	5,91 - 6,89 - 7,87	1500

The loading capacity values are esteemed and verified under static and ideal conditions.

OUTSIDE Ø MAIN PIPE D.E.		SPACER ELEMENTS*	RECOMMENDED SPACING BETWEEN INSULATORS							
			H element ≤ 125 mm				H element ≥ 150 mm			
			Gas		Water		Gas		Water	
Ø MIN	Ø MAX	PCS.	mt	feet	mt	feet	mt	feet	mt	feet
450	510	5	2,5	8,2	2,5	8,2	2,5	8,2	2,5	8,2
540	610	6	2,5	8,2	2,5	8,2	2,5	8,2	2,5	8,2
625	715	7	2,5	8,2	2,5	8,2	2,5	8,2	2,5	8,2
715	805	8	2,5	8,2	2,5	8,2	2,5	8,2	2	6,6
805	895	9	2,5	8,2	2	6,6	2,5	8,2	1,5	4,9
895	985	10	2,5	8,2	2	6,6	2,5	8,2	1,2	3,9
985	1075	11	2,5	8,2	1,5	4,9	2,5	8,2	1,2	3,9
1075	1160	12	2	6,6	1	3,3	2	6,6	1	3,3
1160	1250	13	2	6,6	1	3,3	2	6,6	0,8	2,6
1250	1340	14	2	6,6	1	3,3	2	6,6	0,8	2,6
1340	1430	15	2	6,6	0,8	2,6	1,5	4,9	0,6	2
1430	1520	16	2	6,6	0,8	2,6	1,5	4,9	0,5	1,6
1520	1610	17	2	6,6	0,5	1,6	1,5	4,9	0,5	1,6
1610	1750	18	2	6,6	0,5	1,6	1,5	4,9	0,5	1,6

(\*) number and type of elements to make one insulator ring around the entire circumference of the carrier pipe.

TYPE	H (mm)	PIECES FOR CARTON BOX	CARTON DIMENSIONS (cm)	CARTONS WEIGHT (Kg)	
				Net	Gros
L	25	60	40 x 60 x 50	24	26
	41	42		20	22
	50	30		14,5	16,5
	75	22		15,4	17,4
	100	18		15	17
	125	14		12,6	14,6
	150	12		13	15
	175	10		12	14
	200	8		9,5	11,5

Note: for logistic reasons, deliveries are for full carton boxes only.