

MOD. 13100/E | PIPE DN 400-3000
H. 25-41-60-75-90-110-130 mm



MOD. 13100/H | PIPE DN 400-3000
H. 25-41-60-75-90-110-130 mm

Spacer for pipeline crossings.

CHARACTERISTICS

- Modular system to assemble insulator rings, which allows spacers to be used on a wide pipe diameter range therefore reducing inventory costs.
- Spacers are quickly and easily assembled by manually fitting elements one into the other.
- The tooth insertion method allows on site adjustments to fit a wide range of pipe diameters.
- Spacers are manufactured entirely out of high density polyethylene (HDPE). No metal bolts or attachments are required.
- A low friction coefficient guarantees an easy insertion into the casing.
- Designed and tested to maintain continuous and long term support for the carrier pipe and its contents.
- Spacers provide a constant projection around the entire circumference of the carrier pipe.
- Spacers provide long term protection from corrosion.
- Spacers can be installed on steel-coated pipes, concrete pipes, ductile iron pipes or plastic pipes.
- Heights 25 mm and 41 mm homologated according to SNAM RETE GAS specification (GASD A 09.01.06 and GASD C 09.06.00).
- Available also in a special reinforced version for heavy duty applications (e.g. long crossings and/or big diameters).
- Tightening by tool type B75 for height up to 75 mm, tool type B130 for height from 90 up to 130 mm.

MATERIAL - HDPE

Yield strength*:
≥ 25 N/mm² (test according to UNI EN ISO 527-2)

Elongation at break*:
> 200% (test according to UNI EN ISO 527-2)

Hardness shore D:
64 - ASTM D 2240

Minimum working temperature:
- 20°C (for applications below 5°C contact Raci)

Minimum stocking temperature:
- 5°C (for applications below 5°C contact Raci)

Dielectric strength:
> 37 kV/mm - ASTM D 149/64

UVL stabilization:
Good

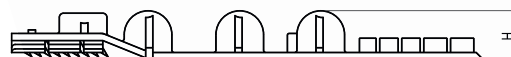

e E

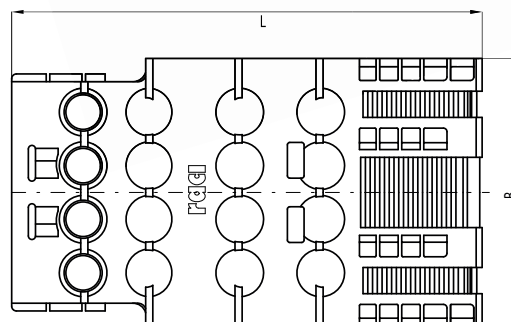

e H

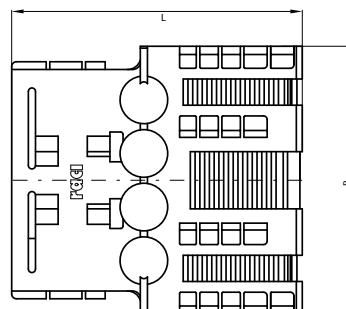

(*) on test specimen with moulded material, realized and tested for every batch of production. Batch number is marked on each element recording nr/year of moulding.

TYPE	USEFUL LENGTH		WIDTH (B)		HEIGHT (H)		LOADING CAPACITY (kg)
	mm	inch	mm	inch	mm	inch	
E	280 - 335	11 - 13,2	225	8,8	25 - 41 - 60	0,98 - 1,61 - 2,36	5000
					75 - 90	2,95 - 3,54	4000
					110 - 130	4,33 - 5,12	3250
H	130 - 185	5,1 - 7,3	225	8,8	25 - 41 - 60	0,98 - 1,61 - 2,36	5000
					75 - 90	2,95 - 3,54	4000
					110 - 130	4,33 - 5,12	3250

The loading capacity values are esteemed and verified under static and ideal conditions.

OUTSIDE MAIN PIPE D.E.		SPACER ELEM.* (pcs.)		RECOMMENDED SPACING BETWEEN											
				H element ≤ 60 mm				≤75 H element ≤90mm				H element ≥ 110 mm			
Ø MIN	Ø MAX	Family		Gas		Water		Gas		Water		Gas		Water	
		E	H	mt	feet	mt	feet	mt	feet	mt	feet	mt	feet	mt	feet
421	465	4	1	3,5	11,5	3,3	10,8	3,3	10,8	2,8	9,2	2,5	8,2	2,0	6,6
466	530	5	-	3,5	11,5	3,3	10,8	3,3	10,8	2,8	9,2	2,5	8,2	2,0	6,6
531	630	6	-	3,3	10,8	3,3	10,8	2,8	9,2	2,8	9,2	2,0	6,6	2,0	6,6
631	730	7	-	3,3	10,8	3,3	10,8	2,8	9,2	2,8	9,2	2,0	6,6	2,0	6,6
731	830	8	-	3,3	10,8	3,0	9,8	2,8	9,2	2,5	8,2	2,0	6,6	1,8	5,9
820	910	9	-	3,3	10,8	3,0	9,8	2,8	9,2	2,5	8,2	2,0	6,6	1,8	5,9
910	1030	10	-	3,3	10,8	2,5	8,2	2,8	9,2	2,4	7,9	2,0	6,6	1,5	4,9
1031	1159	11	-	3,3	10,8	2,5	8,2	2,8	9,2	2,2	7,2	2,0	6,6	1,5	4,9
1160	1360	13	-	3,3	10,8	2,5	8,2	2,8	9,2	2,0	6,6	2,0	6,6	1,2	3,9
1361	1600	15	-	3,3	10,8	2,0	6,6	2,8	9,2	1,5	4,9	2,0	6,6	1,2	3,9
1601	1799	17	-	3,3	10,8	1,5	4,9	2,8	9,2	1,2	3,9	2,0	6,6	1,0	3,3
1800	2110	20	-	3,3	10,8	1,2	3,9	2,8	9,2	1,0	3,3	2,0	6,6	0,8	2,6
2111	2430	23	-	3,0	9,8	0,9	2,9	2,5	8,2	0,8	2,6	1,5	4,9	0,6	2
2431	2860	27	-	3,0	9,8	0,7	2,3	2,5	8,2	0,5	1,6	1,5	4,9	0,4	1,3
2861	3414	32	-	3,0	9,8	0,7	2,3	2,5	8,2	0,5	1,6	1,5	4,9	0,4	1,3

(*) number and type of elements to make one insulator ring around the entire circumference of the carrier pipe.

(**) The element H was designed as special pipe sizes for closing element in order to complete the circumferences on some pipe OD ranges. Therefore it is not possible to use more than 1 elements H in a ring.

TYPE	H (mm)	PIECES FOR CARTON BOX	CARTON DIMENSIONS (cm)	CARTONS WEIGHT (Kg)	
				Net	Gros
E	25	50	60 x 40 x 50	28	30
	41	26		18	20
	41 (R)*	26		20	22
	60	18		15	17
	75	14		14	16
	90	12		14	16
	110	10		13	15
	130	8		10	12
H	25	60	60 x 40 x 50	21	23
	41	58		22	24
	60	40		16	18
	75	30		13	15
	90	26		12	14
	110	22		10	12
	130	20		9	11

Note: for logistic reasons, deliveries are for full carton boxes only.

(*) R = Reinforced.